

NOTICE!!

These documents have been scanned!

Do not place un-scanned documents beneath this notice!

Do not remove this notice from this file!

GPO Jacket No. 560-102
Print Order 61540
Rise Business Services, LLC
Job=AZ15 4/29/2019



Box Number= AZ15005



Claim Begin-End: AMC446088-AMC446088

1 Initial Receipt



AZ15005-25

AMC450400-AMC453366

United States Department of the Interior
Bureau of Land Management
 DIV OF LANDS, MINRLS & ENERGY
 ONE N CENTRAL AVE
 PHOENIX, AZ 85004 -4427
 Phone: 602-417-9200

Receipt

No: 3999381

Transaction #: 4109791	
Date of Transaction: 10/19/2017	
CUSTOMER:	
	MATTHEW LEATHERMAN 18133 W CARMEN DR SURPRISE, AZ 85388-1671 US

ENTERED
 OCT 25 2017
 BY: *Ram*

LINE #	QTY	DESCRIPTION	REMARKS	UNIT PRICE	TOTAL
1	1.00	LOCATABLE MINERALS / MINING CLAIMS-NEW, UNADJUD, ONE OR MORE AUTH NOS / NEW MINING CLAIM PROCESSING FEE CASES: AMC446088/\$20.00		- n/a -	20.00
2	1.00	LOCATABLE MINERALS / MINING CLAIMS-NEW, UNADJUD, ONE OR MORE AUTH NOS / NEW MINING CLAIMS LOCATION FEE CASES: AMC446088/\$37.00		- n/a -	37.00
3	1.00	LOCATABLE MINERALS / MINING CLAIMS-NEW, UNADJUD, ONE OR MORE AUTH NOS / NEW MINING CLAIMS MAINTENANCE FEE CASES: AMC446088/\$155.00		- n/a -	155.00
TOTAL:					\$212.00

PAYMENT INFORMATION				
NOTE: Items will appear on credit card statement as "Bureau of Land Mgmt CO".				
1	AMOUNT:	212.00	POSTMARKED:	N/A
	TYPE:	CREDIT CARD	RECEIVED:	10/19/2017
	NAME:	LEATHERMAN, MATTHEW 18133 W CARMEN DR SURPRISE AZ 85388-1671 US		
	CARD NO:	XXXXXXXXXXXX9387	AUTH CODE:	02656Z
	NAME ON CARD:	FRED W DICKINSON		
	EXPIRES:	03/2022		
	SIGNATURE:			

NOTICE!!

These documents have been scanned!

Do not place un-scanned documents beneath this notice!

Do not remove this notice from this file!

GPO Jacket No. 560-102
Print Order 61540
Rise Business Services, LLC
Job=AZ15 4/29/2019



Box Number= AZ15005



Claim Begin-End: AMC446088-AMC446088

2 Correspondence



AZ15005-25

AMC450400-AMC453366

**NO
DOCUMENTS
FOUND**

NO DOCUMENTS FOUND
NO DOCUMENTS FOUND

NOTICE!!

These documents have been scanned!

Do not place un-scanned documents beneath this notice!

Do not remove this notice from this file!

GPO Jacket No. 560-102
Print Order 61540
Rise Business Services, LLC
Job=AZ15 4/29/2019



Box Number= AZ15005



Claim Begin-End: AMC446088-AMC446088

3 Transfers



AZ15005-25 AMC450400-AMC453366

QUIT CLAIM DEED

FOR VALUABLE CONSIDERATION, the sufficiency and receipt of which is hereby acknowledged, Matthew G Leatherman does hereby forever quit claim all his right, title and interest in the unpatented mining claims described on the supplemental attachment, attached hereto and incorporated herein by reference, to AMC 446088.

IN WITNESS WHEREOF, grantor has executed this instrument as of this 23 day of April, 2019

Matt

Exempt from A.R.S. 11-1133 and 11-1137(B) by A.R.S. 11-1134(A)(6)

STATE OF ARIZONA)
County of Maricopa) ss.

SUBSCRIBED AND SWORN TO before me, a Notary Public, this 23 day of April, 2019

By: Matthew G. Leatherman and Jesse Bieschke

Notary Public [Signature]

My Commission Expires 9/30/20



Nicole Goodman
Notary Public
Maricopa, Arizona
My Comm. Expires 09/30/20

AMC # 446088 Placer Mining Claims Leatherman's Hill

Grantor: Matthew G Leatherman Matt

Grantee: Jesse Bieschke
340 W Wickenburg Way Suite A
Wickenburg, AZ 85390 [Signature]

Form MCF120
Revised July 2014

This form is available from the Arizona Geological Survey and may be reproduced

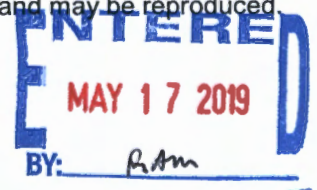

**United States Department of the Interior
Bureau of Land Management
DIV OF LANDS, MINRLS & ENERGY
ONE N CENTRAL AVE
PHOENIX, AZ 85004 -4427
Phone: 602-417-9200**

Receipt

No: 4454741

Transaction #: 4574420	
Date of Transaction: 05/15/2019	
CUSTOMER:	
JESSE BIESHKE 7402 E GRAND RIVER AVE PORTLAND,MI 48875-7703 US	

LINE #	QTY	DESCRIPTION	REMARKS	UNIT PRICE	TOTAL
1	1.00	LOCATABLE MINERALS / MINING CLAIMS- NOT NEW-UNADJUD, ONE AUTH NO. ONLY / MINING CLAIM MONEY RECEIVED CASES: AMC446088/\$15.00	TRF/1	- n/a -	15.00
TOTAL:					\$15.00

PAYMENT INFORMATION			
NOTE: Items will appear on credit card statement as "Bureau of Land Mgmt CO".			
1	AMOUNT:	15.00	POSTMARKED: N/A
	TYPE:	CREDIT CARD	RECEIVED: 05/15/2019
	NAME:	BIESHKE, JESSE 7402 E GRAND RIVER AVE PORTLAND MI 48875-7703 US	
	CARD NO:	XXXXXXXXXXXX4847	AUTH CODE: 464934
	NAME ON CARD:	JESSE BIESHKE	
	SIGNATURE:		

REMARKS
CALL IN - INFO REC'D BY EUGENE

This receipt was generated by the automated BLM Collections and Billing System and is a paper representation of a portion of the official electronic record contained therein.

**NO
DOCUMENTS
FOUND**

NO DOCUMENTS FOUND
NO DOCUMENTS FOUND

NOTICE!!

These documents have been scanned!

Do not place un-scanned documents beneath this notice!

Do not remove this notice from this file!

GPO Jacket No. 560-102
Print Order 61540
Rise Business Services, LLC
Job=AZ15 4/29/2019



Box Number= AZ15005



Claim Begin-End: AMC446088-AMC446088

4 Annual Filings



AZ15005-25

AMC450400-AMC453366

UNITED STATES
DEPARTMENT OF THE INTERIOR
BUREAU OF LAND MANAGEMENT

446088

CREDIT CARD PAYMENT
For Mining Claim Maintenance Fee

THIS IS A CHANGE OF ADDRESS

TELEPHONE SUBMISSION - ACCURACY OF THE BELOW INFORMATION IS THE RESPONSIBILITY OF THE CLAIMANT/OWNER

NAME Jesse Bieschke
ADDRESS 7600 State Hwy 165 *7000 dit card*
CITY Wichita Pueblo STATE CO ZIP 81004
PHONE # _____

SEND RECEIPT TO Above address
 Other (Include Name and Mailing Address):

my address →

J.B.
340 W Wichem Way STA
Wichem 85390

AMC NUMBER

AMC 446088

CLAIM/SITE NAME

1 # of Claim/Site
x 165.00 Each
\$165.00 Total Charged PET (INITIALS)

RECEIPT # 4532084

DATE STAMP

RECEIVED
STATE OFFICE
2019 AUG 14 A 9:40
PHOENIX, ARIZONA

**** FOR OFFICIAL USE ONLY ****

DATE _____ INITIALS _____ VERIFIED _____

ENTERED
BY [Signature]

DEPARTMENT OF THE INTERIOR
BUREAU OF LAND MANAGEMENT
MINING CLAIMS
(MASS) Serial Register Page

Run Date/Time: 8/14/2019 10:47 AM

Page 1 Of 1

01 10-21-1976;090STAT0090;43USC1744
Case Type 384201: PLACER CLAIM
Claim Name: LEATHERMANS HILL
Case Disposition: ACTIVE
Required Maintenance Fee: \$165.00

Total Acres
20

Serial Number
AMC446088

Lead File Number
AMC446088

Name & Address	Interest Relationship
BIESCHKE JESSE 340 W WICKENBURG WAY STE A WICKENBURG, AZ 85390-4238	CLAIMANT

County / State	District
YAVAPAI COUNTY, AZ	PHOENIX DO

Mer Twp Rng Sec	Subdivision
14 0090N 0040W 033	SE

Act Date	Code	Action Text	Action Remarks	Receipt Number
09/02/2017	403	LOCATION DATE		
10/19/2017	395	RECORDATION NOTICE RECD	1	3999381
08/07/2018	782	MAINTENANCE FEE PAYMENT	2019;\$155	4229952
10/19/2017	484	LOCATION YEAR / MAINTENAN	2018;\$155	3999381
05/15/2019	396	TRF OF INTEREST FILED	LEATHERMAN MATTHEW G	4454741
05/18/2018	669	LAND STATUS CHECKED		
10/19/2017	501	ACCT ADV IN LEAD FILE	AMC446088;	

Line Nr	Remarks
---------	---------

United States Department of the Interior
Bureau of Land Management
 DIV OF LANDS, MINRLS & ENERGY
 ONE N CENTRAL AVE
 PHOENIX, AZ 85004 -4427
 Phone: 602-417-9200

Receipt	
No:	4532084

Transaction #: 4652951
Date of Transaction: 08/14/2019

CUSTOMER:	
JESSE BIESCHKE 340 W WICKENBURG WAY SUITE 1 WICKENBURG,AZ 85390-5228 US	

LINE #	QTY	DESCRIPTION	REMARKS	UNIT PRICE	TOTAL
1	1.00	LOCATABLE MINERALS / MINING CLAIMS- NOT NEW-UNADJUD,ONE AUTH NO. ONLY / MINING CLAIM MONEY RECEIVED CASES: AMC446088/\$165.00	2020 MAINT/1	- n/a -	165.00
TOTAL:					\$165.00

PAYMENT INFORMATION				
NOTE: Items will appear on credit card statement as "Bureau of Land Mgmt CO".				
1	AMOUNT:	165.00	POSTMARKED:	N/A
	TYPE:	CREDIT CARD	RECEIVED:	08/14/2019
	NAME:	BIESCHKE, JESSE 7600 STATE HWY 165 PUEBLO CO 81004 US		
	CARD NO:	XXXXXXXXXXXX0086	AUTH CODE:	000003
	NAME ON CARD:	JESSE BIESCHKE		
	SIGNATURE:	OVER THE PHONE		

REMARKS

This receipt was generated by the automated BLM Collections and Billing System and is a paper representation of a portion of the official electronic record contained therein.

DEPARTMENT OF THE INTERIOR
BUREAU OF LAND MANAGEMENT
MINING CLAIMS

Run Date/Time: 8/20/2018

MC Maintenance Fees Paid Through the BLM Pay Portal
(by Date Paid)

Page 21 Of 316

CBS Receipt: 4229952

Printed For Lead File # AMC446088

Agency Tracking ID: 1533672599

Assessment Year: 2019

Paid On: 8/7/2018

Number of BLM Serial Nr: 1

Total Amount Paid: \$155.00

Claim Name	BLM Serial No	Lead File No	Amount Paid
LEATHERMANS HILL	AMC446088	AMC446088	\$155.00

United States Department of the Interior
Bureau of Land Management
 BUSINESS & SUPPORT SVCS DIV
 ONE N CENTRAL AVE SUITE 800
 PHOENIX, AZ 85004 -4427
 Phone: 602-417-9200

Receipt

No: 4229952

Transaction #: 4345228	
Date of Transaction: 08/07/2018	
CUSTOMER:	
MATTHEW LEATHERMAN 18133 W CARMEN DR. SURPRISE, AZ 85388 US	

LINE #	QTY	DESCRIPTION	REMARKS	UNIT PRICE	TOTAL
1	1.00	LOCATABLE MINERALS / MINING CLAIMS- NOT NEW-UNADJUD, ONE AUTH NO. ONLY / MINING CLAIM MONEY RECEIVED CASES: AMC446088/\$155.00		- n/a -	155.00
TOTAL:					\$155.00

PAYMENT INFORMATION			
NOTE: Items will appear on credit card statement as "BLM O Mining Claim".			
1	AMOUNT:	155.00	POSTMARKED: N/A
	TYPE:	CREDIT CARD	RECEIVED: 08/07/2018
	NAME:	MATTHEW LEATHERMAN 18133 W CARMEN DR. SURPRISE AZ 85388 US	
	CARD NO:	XXXXXXXXXXXX7972	AUTH CODE: 282710
	NAME ON CARD:	MATTHEW LEATHERMAN	
	SIGNATURE:		

REMARKS

This receipt was generated by the automated BLM Collections and Billing System and is a paper representation of a portion of the official electronic record contained therein.

NOTICE!!

These documents have been scanned!

Do not place un-scanned documents beneath this notice!

Do not remove this notice from this file!

GPO Jacket No. 560-102
Print Order 61540
Rise Business Services, LLC
Job=AZ15 4/29/2019



Box Number= AZ15005



Claim Begin-End: AMC446088-AMC446088

5 Miscellaneous



AZ15005-25

AMC450400-AMC453366

**NO
DOCUMENTS
FOUND**

NO DOCUMENTS FOUND
NO DOCUMENTS FOUND

NOTICE!!

These documents have been scanned!

Do not place un-scanned documents beneath this notice!

Do not remove this notice from this file!

GPO Jacket No. 560-102
Print Order 61540
Rise Business Services, LLC
Job=AZ15 4/29/2019



Box Number= AZ15005



Claim Begin-End: AMC446088-AMC446088

6 Location Notices-Amendments and Supporting Documents



AZ15005-25 AMC450400-AMC453366

MINING CLAIM STATUS REPORT

Data Entered: 10/25/17 ram

MTP Checked By: EB

GEO Checked By: EB

LEAD SERIAL NUMBER: AMC 446088 thru AMC

NUMBER OF CLAIMS & TYPE:

LODE _____
1 PLACER _____
ASSOCIATION PLACER _____
MILL SITE _____
TUNNEL SITE _____

CHARGES:

Processing Fee @ \$20 = \$ 20
Location Fee @ \$37 = \$ 37
Maintenance Fee @ \$155 = \$ 155
Add'l Maint Fee for Assoc Placer = \$ _____
SUBTOTAL \$ 212
Other Fees \$ _____
Other Fees \$ _____
TOTAL \$ _____

TOTAL ACREAGE: 20 Per Claim
(Placer Only)

NUMBER OF LOCATORS: 1

DOCUMENTS RECEIVED VIA : Over-the-Counter Mail **TIMELY FILED:** Yes No

LEGAL DESCRIPTION: T 9N R 4W SEC 33
T _____ R _____ SEC _____
T _____ R _____ SEC _____
T _____ R _____ SEC _____
T _____ R _____ SEC _____

BLM FOREST SERVICE SUBJ TO PL 359: Yes No
WILDERNESS AREA

SPLIT ESTATE: N/A SX PX OTHER
SRHA Was proper Notice filed if located on SHRA Land? Yes No

RECONVEYED MINERALS ON BLM LAND REQUIRE OPENING ORDER FROM 1944 TO 1993:

Open to Entry On _____ N/A

COMMENTS/STATUS: VOID PARTIALLY VOID PVT MINERALS WITHDRAWN LANDS
OTHER

AMC 446088

Claimant acknowledges that portions of the following claim(s) site(s) may be void or voidable.

Printed Name of Claimant _____ Signature of Claimant _____

*****FINAL ADJUDICATION*****

DATE 5/18/2018 INITIALS sm

LOCATION NOTICE FOR PLACER MINING CLAIM

□ Amendment BLM Serial # _____

NOTICE IS HEREBY GIVEN that the **Leatherman's Hill** placer mining claim has been located by **Matthew G. Leatherman** whose current mailing address is:

18133 W. Carmen Dr., Surprise, AZ 85388

BLM
Date
Stamp
2017 OCT 19 P 2:02
PHOENIX, ARIZONA

RECEIVED
BLM AZ STATE OFFICE

The general course of this claim is **East to West** and it is situated in **Yavapai** County, Arizona. This claim is **1320** feet in length and **660** feet in width.

20 Acres Total Claim Acreage. This claim runs from the location monument on which this location notice is posted at the **NW** corner of the claim approximately **660** feet in a **South** direction from the **North** end line and **1320** feet in a **East** direction from the **West** end line. This claim is marked by four monuments, one at each corner of the claim. The location monument on which this notice is posted is situated within Section **33**, Township **9N**, Range **4W**, Gila Salt River Base and Meridian, Arizona. This claim encompasses portions of the following legal subdivision(s) if located by legal subdivision or the following quarter section(s), section(s), Township(s) and Range(s) **N 1/2 of the SW 1/4 of the SE 1/4 of Sec. 33, T9N, R4W**, Gila Salt River Base and Meridian, Arizona. The locality of this claim with reference to some natural object or permanent monument and additional information (if any) concerning its locality are as follows: **The SE corner of the claim is 1320' West and 660' North of the SE Corner of Sec 33, T9N, R4W.**

The above information is shown on the attached map. DATED AND POSTED on the ground this **2nd** day of **September, 2017**.

Locators:

Printed Name Matthew Leatherman Signature(s) *Matthew Leatherman*

Printed Name _____ Signature(s) _____

AMC 446088

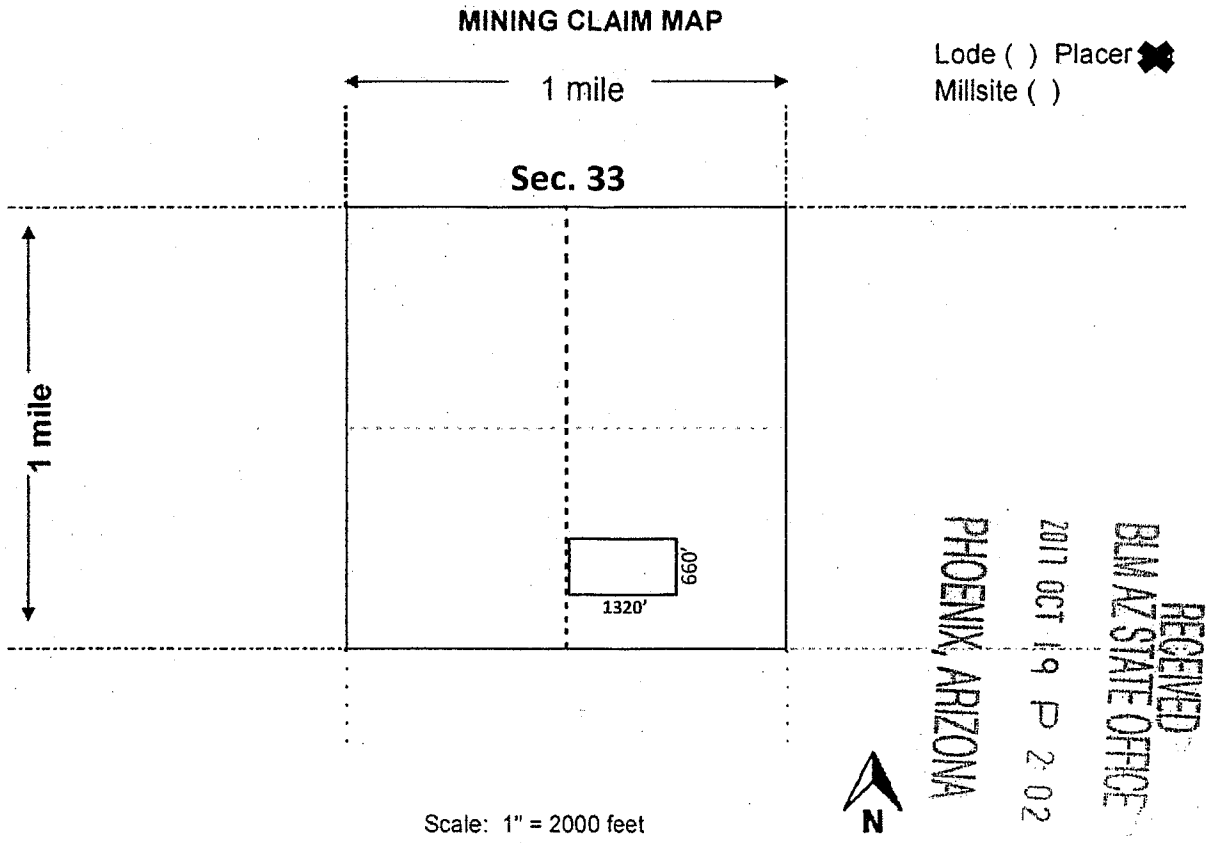

1. The above map depicts the **Leatherman's Hill** mining claim, which is located in Section(s) **33**, Township **9N**, Range **4W**, Gila and Salt River Base and Meridian, **Yavapai** County, Arizona.

Total claim acreage is **20 Acres**.

2. The type of corner and location monuments used are as follows: **Capped PVC, Standing >5' tall.**

3. The bearings and distances in degrees and feet between claim corners and to a public land survey monument are as depicted on the map. **The SE corner of the claim is 1320' West and 660' North of the SE Corner of Sec 33, T9N, R4W.**

4. If the claim is a placer or millsite claim with exterior limits conforming to legal subdivisions of the public survey, provide a legal description of the claim **The N 1/2 of the SW 1/4 of the SE 1/4 of Sec. 33, T9N, R4W of the Gila and Salt River Base and Meridian, Yavapai County, Arizona.**

AMC446088

Input Parameters for Geographic Report with Land

System Id = CR

Admin State = AZ

Geo State =

Casetype Begins With

Case Disp Txt = AUTHORIZED, CANCELLED, EXPIRED, PENDING, REJECTED, RELINQUISHED, VOID, WITHDRAWN

Mer Twp Rng =

Section =

Mtrs = 14 0090N 0040W 033, 14 0090N 0040W 999

Commodity =

Commodity Txt =

Pending Org =

Pend Org Decode =

Total Rows Returned: 3

RUN TIME: 01:45 PM

UNITED STATES DEPARTMENT OF INTERIOR
BUREAU OF LAND MANAGEMENT
GEOGRAPHIC REPORT WITH LAND
Sorted by Serial Number

RUN DATE: 10/19/2017
Page 1 of 1

Adm State: AZ

Serial Number: AZA 024160
Total Case Acres: 1.000

<u>Casetype</u>	<u>Case Disp</u>				<u>Sect</u>	<u>Sur Typ</u>	<u>Sur Num</u>	<u>Suff</u>	<u>Subdivision</u>	<u>Act Pend</u>
293200	EXPIRED	14	0090N	0040W	033	FF		1	PORTION OF;	

Serial Number: AZA 031568
Total Case Acres: 1.000

<u>Casetype</u>	<u>Case Disp</u>				<u>Sect</u>	<u>Sur Typ</u>	<u>Sur Num</u>	<u>Suff</u>	<u>Subdivision</u>	<u>Act Pend</u>
293200	EXPIRED	14	0090N	0040W	033	FF			PORTION OF;	

Serial Number: AZA 035151
Total Case Acres: 1.000

<u>Casetype</u>	<u>Case Disp</u>				<u>Sect</u>	<u>Sur Typ</u>	<u>Sur Num</u>	<u>Suff</u>	<u>Subdivision</u>	<u>Act Pend</u>
293200	PENDING	14	0090N	0040W	033	FF			PORTION OF;	

